

Specification

Model	HWRA2F	HWRA4F	HWRA6F	HWRA8F
Number of circuits	2-circuit	4-circuit	6-circuit	8-circuit
Operating fluid	Ordinary mineral oil-based hydraulic oil (equivalent to ISO-VG32) or air			
Maximum operating pressure (MPa)	25			
Allowed RMPs	Different due to different pressure			
Operating environment temperature (°C)	0~70			
Piping interface size	Rp1/4 (the bottom of the main body is the seat cushion piping)			
Mass (kg)	4.9	6.1	10.9	14.9

6-circuit

HWRA6F

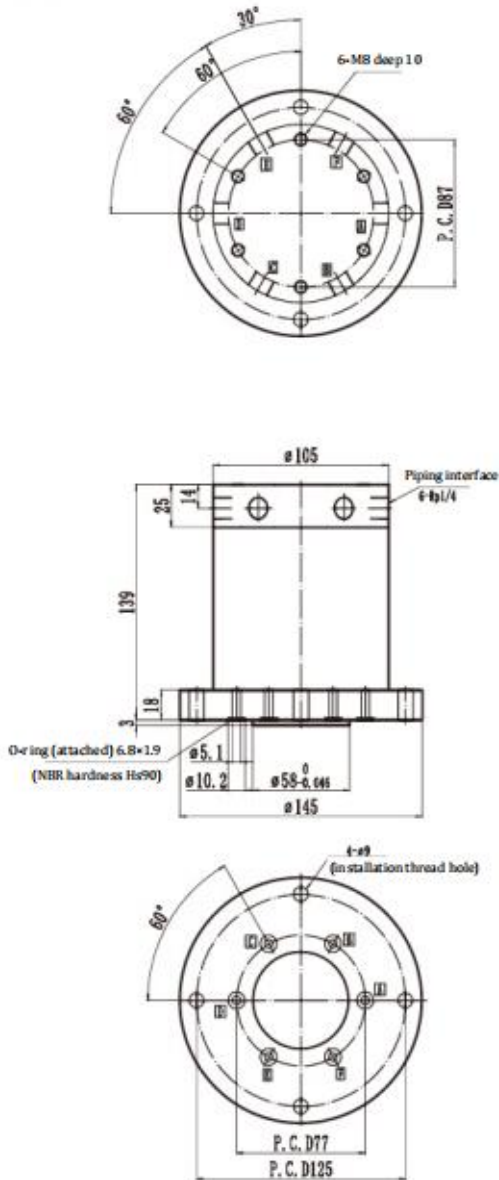

A to F mark numbers are printed on each piping interface. The maximum surface roughness of the installation surface shall be maintained below Ra1.6.

8-circuit

HWRA8F

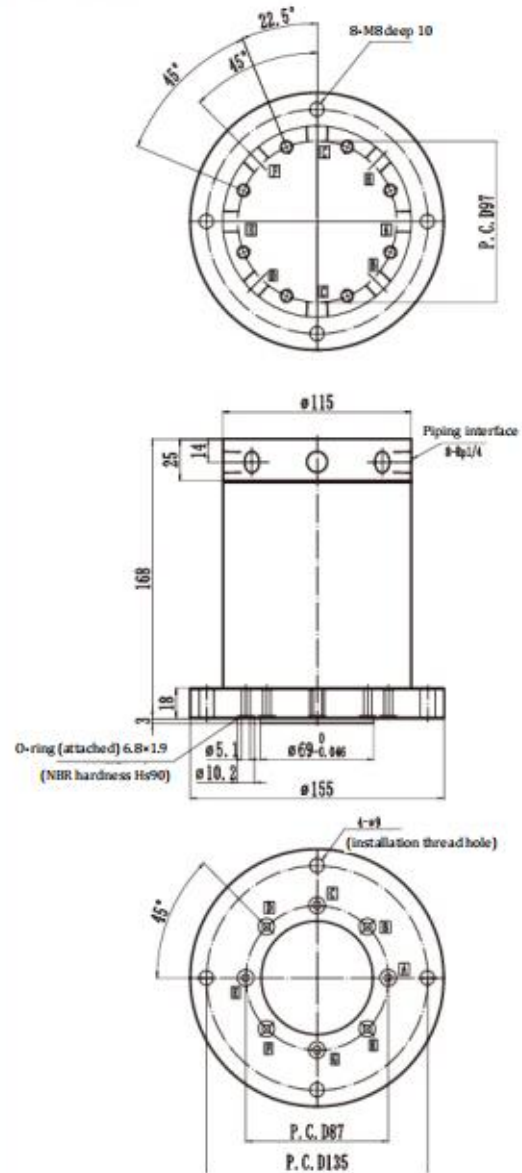

A to H mark numbers are printed on each piping interface. The maximum surface roughness of the installation surface shall be maintained below Ra1.6.