



Single rotary table flange type

25MPa

The main installation part of the single rotary table flange type is in the shape of a flange, which reduces the overall height and makes the structure compact. There are four types from 2-circuit to 8-circuit, and each circuit can be used independently. Please supply oil from the flange side of the main body through cushion piping.

2-circuit

HWRA2

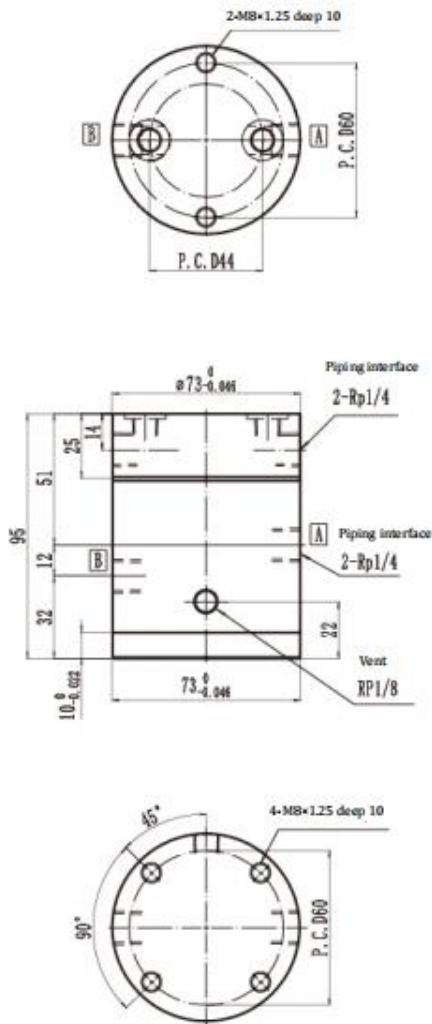

A to B mark numbers are printed on each piping interface. The maximum surface roughness of the installation surface shall be maintained below Ra1.6.

4-circuit

HWRA4

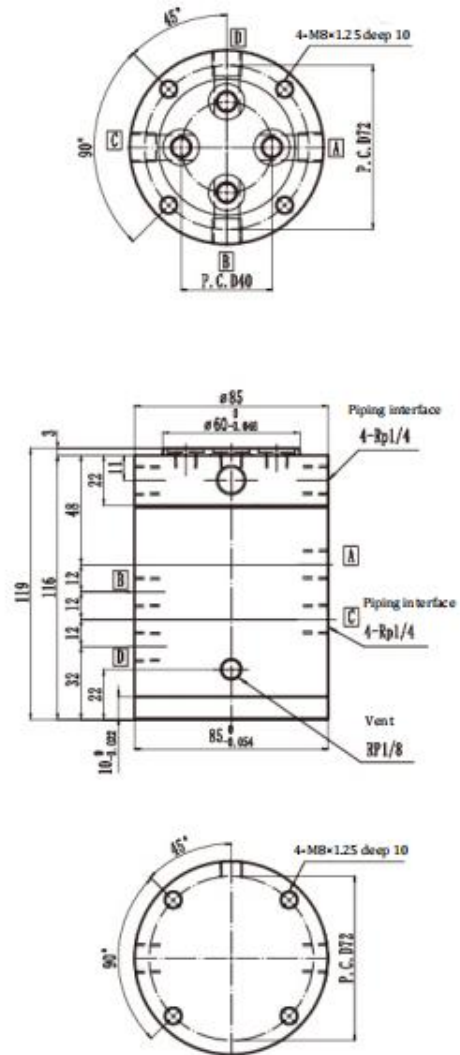

A to D mark numbers are printed on each piping interface. The maximum surface roughness of the installation surface shall be maintained below Ra1.6.

Specification

Model	HWRA2	HWRA4	HWRA6	HWRA8
Number of circuits	2-circuit	4-circuit	6-circuit	8-circuit
Operating fluid	Ordinary mineral oil-based hydraulic oil (equivalent to ISO-VG32) or air			
Maximum operating pressure (MPa)	25			
Allowed RMPs	Different due to different pressure			
Operating environment temperature (°C)	0~70			
Piping interface size	Rp1/4 (Rp1/8 for the upper hole thread of the main body)			
Mass (kg)	3.0	5.0	8.9	12.9

6-circuit

HWRA6

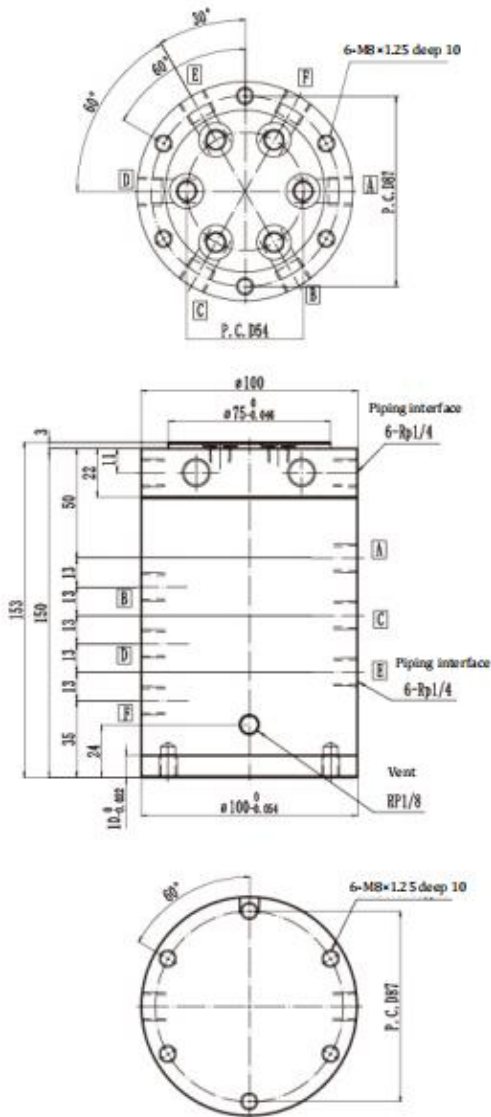

A to F mark numbers are printed on each piping interface. The maximum surface roughness of the installation surface shall be maintained below Ra1.6.

8-circuit

HWRA8

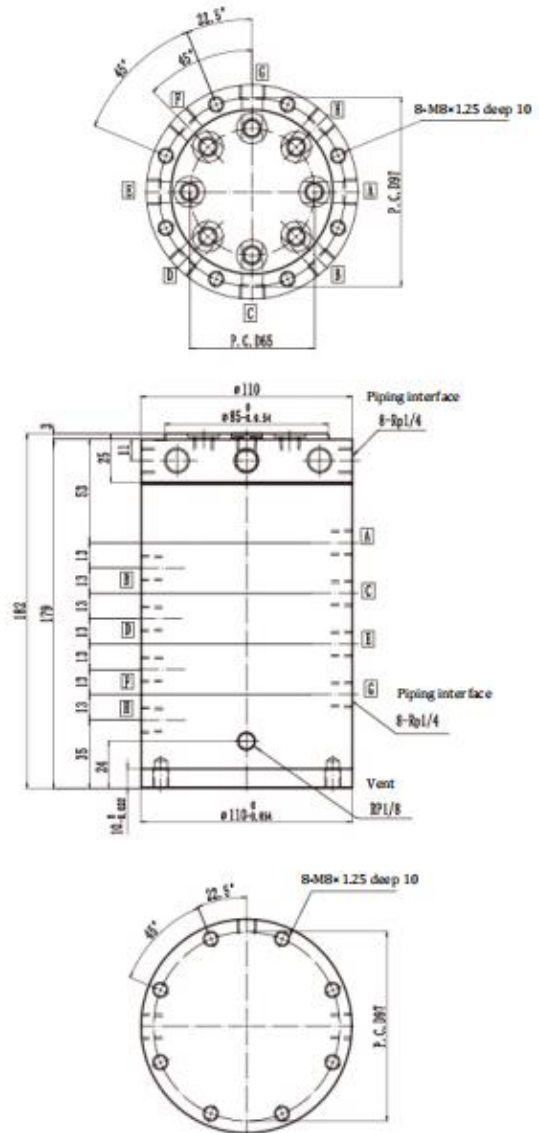

A to H mark numbers are printed on each piping interface. The maximum surface roughness of the installation surface shall be maintained below Ra1.6.